

# X-Wave<sup>2</sup>

## Product Guide



# X-Wave<sup>2</sup> Color Options

**CAR**-Carnival: Yellow, Red, Blue

**EAR**-Earthtone: Hunter Green, Brown, Cedar

**BER**-Berry: Lime Green, Purple, Blue

**ROC**-Rocket: Silver, Red, Blue

## X-Wave<sup>2</sup> Component Part List

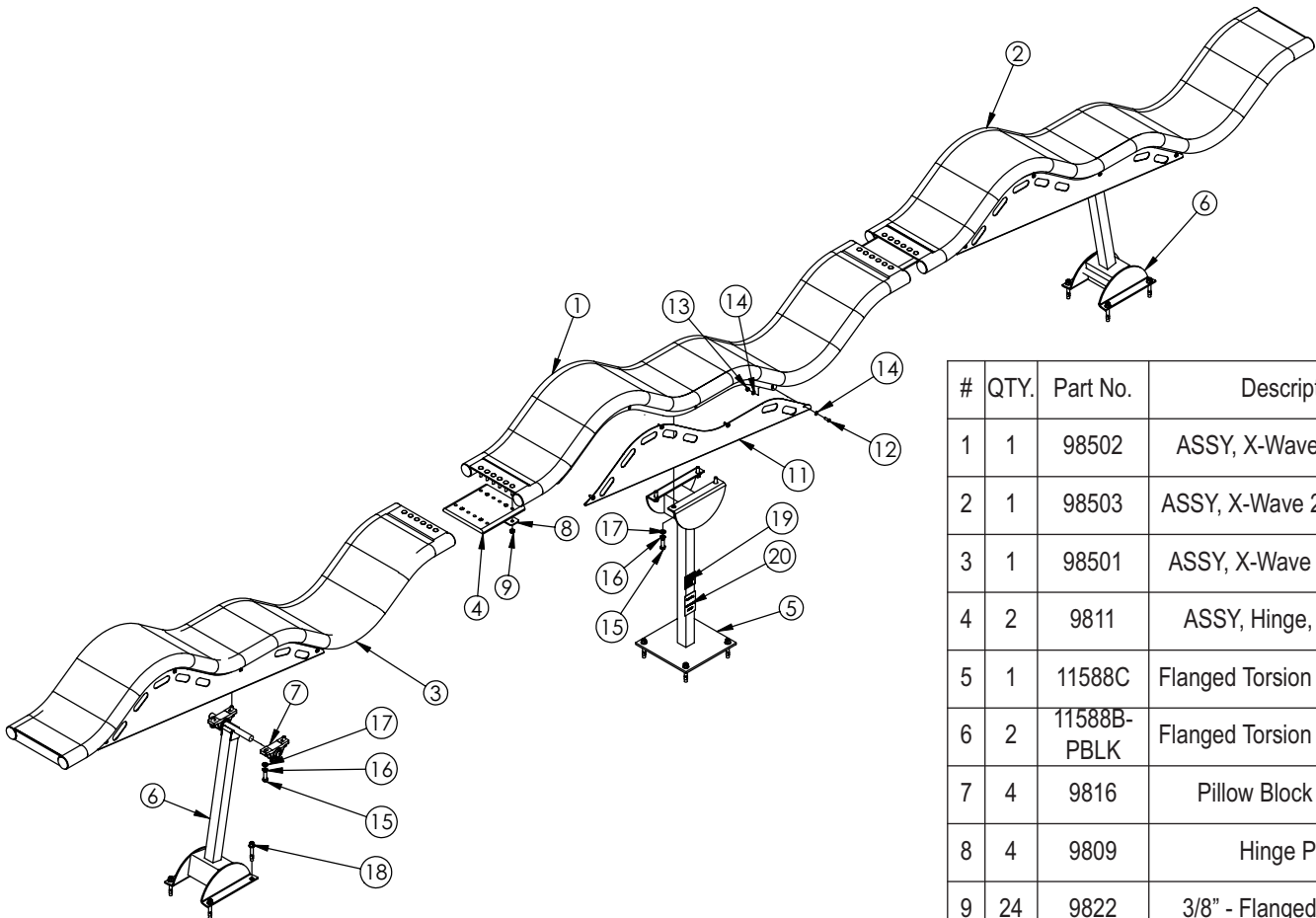

#	QTY.	Part No.	Description
1	1	98502	ASSY, X-Wave 2, Center
2	1	98503	ASSY, X-Wave 2, Right End
3	1	98501	ASSY, X-Wave 2, Left End
4	2	9811	ASSY, Hinge, No Pinch
5	1	11588C	Flanged Torsion Spring Assy
6	2	11588B-PBLK	Flanged Torsion Spring Assy
7	4	9816	Pillow Block Bearing
8	4	9809	Hinge Plate
9	24	9822	3/8" - Flanged Lock Nut
10	3	98506	Dip Assembly, Right Panel
11	3	98507	Dip Assembly, Left Panel
12	24	1001002	5/16" - 18 x 7/8" Button Head
13	24	10012	5/16" - 18 Nylon Lock Nut
14	48	10011	Washer Flat, 5/16"
15	12	99504	1/2" - 13 x 1.5" Hex Head Stainless
16	12	9910	Washer, Lock, .500
17	12	9825	Washer, SS, .50 ID x 1.0 OD
18	12	9835	1/2" Wedge Anchor
19	1	9830	Label, Warning
20	1	9832	Label, Grades K-6

### X-Wave Tools List

- |                            |                     |
|----------------------------|---------------------|
| Torque Wrench              | 1/2" Socket         |
| 9/16" Deep Well Socket     | 1/2" Wrench         |
| Allen Wrench Set, Standard | 7/16" Wrench        |
| Chalk Line & Chalk         | C-Clamp             |
| Hammer                     | Grease Gun & Grease |
| Level                      | Hammer Drill        |
| 1/2" Hammer Drill Bit      | Tape Measure        |
| 3/8" Drive Ratchet         |                     |

# X-Wave<sup>2</sup> Use Zone

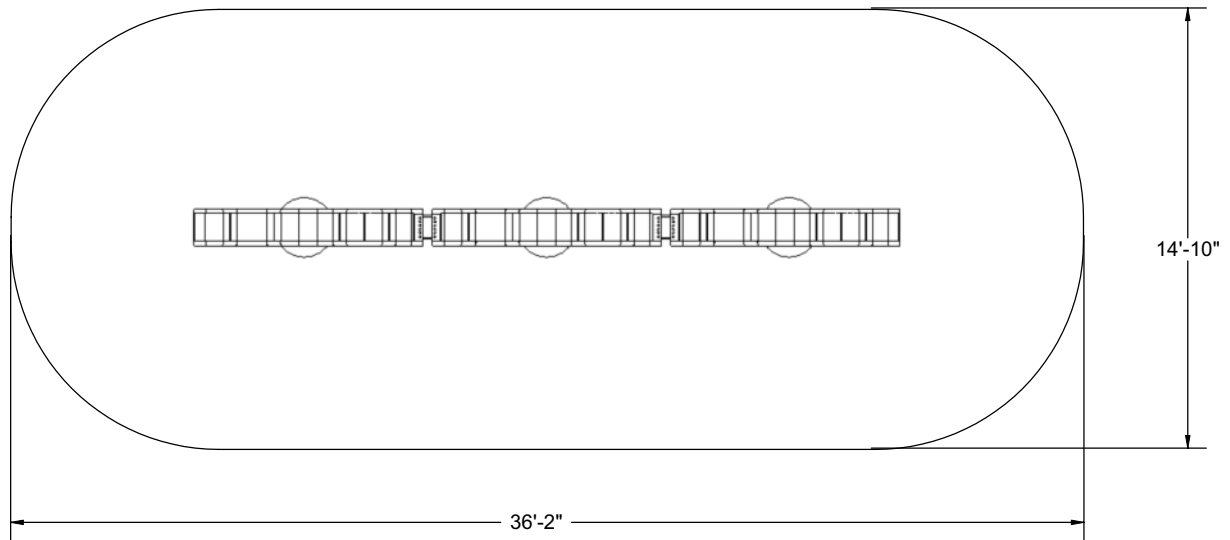

## X-Wave<sup>2</sup> Footings

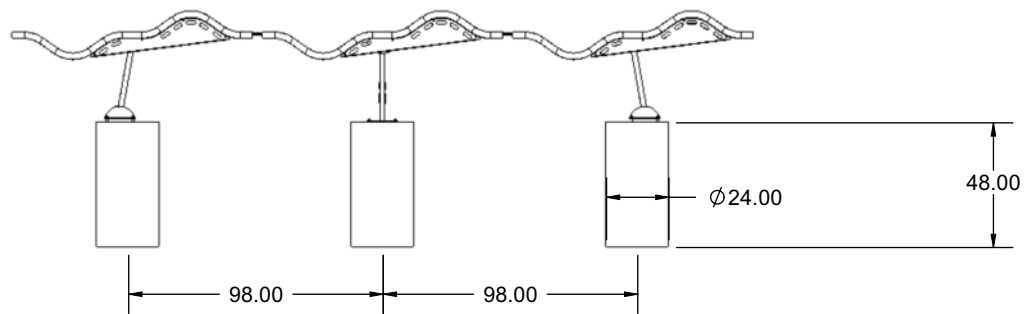

Notice: Outer legs must be bent toward center.  
Each outer leg will have a 2" offset from level.

### 1.) Prepare Installation Site:

- Grade must be level (Critical)
- Provide a minimum of 7' play zone all around X-Wave from other structures/play units

### 2.) Properly mark footing locations by snapping a chalk & measuring the center-to-center distance. (Critical)

### 3.) Drill or dig each footing to allow for a concrete form 48" in length to be properly positioned.

Place form in hole & secure its position by back-filling.

### 4.) Pour concrete. Concrete shall be level with the top edge of each form. Let concrete fully cure before installing X-Wave.

# X-Wave<sup>2</sup> Assembly

## STEP 1: CENTER LEG

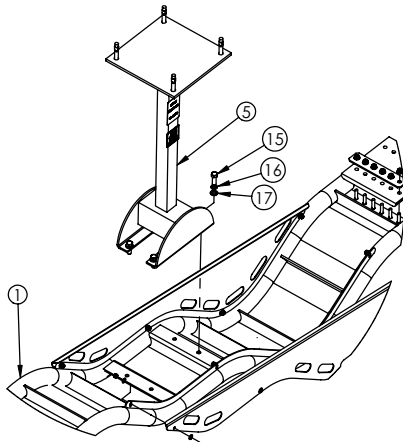

Locate the center section of the X-Wave (1) and lay it upside down on a protective surface. Place the center torsion leg (5) over the mounting holes and attach using four ½" x 1.5" bolts (15), flat washers (17) and lock washers (16). Do not tighten bolts at this time.

## STEP 2: LEG TO TOP

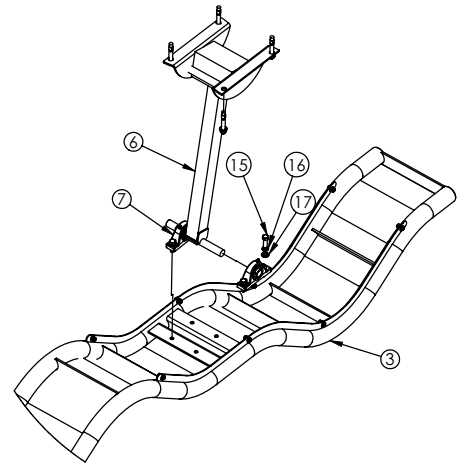

Locate both end sections of the X-Wave (2 and 3) and lay them upside down on a protective surface. Place one pillow block bearing (7) on each shaft of the torsion leg (6) with the set screws facing outward. Place the pillow block bearings over the mounting holes, ensuring that the stop pin on the leg is facing the center of the X-Wave and attach using four ½" x 1.5" bolts (15), flat washers (17) and lock washers (16). Do not tighten bolts at this time. Repeat with the second end of the X-Wave.

## STEP 3: HINGES

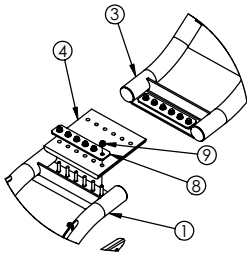

Align the three sections of the X-Wave so that the hinges (4) can be installed. Place the hinge over the studs and secure with the hinge plate (8) and 3/8" flanged lock nuts (9). Torque nuts to 25 ft-lbs. Repeat with the second hinge.

## STEP 4: SIDE PANELS

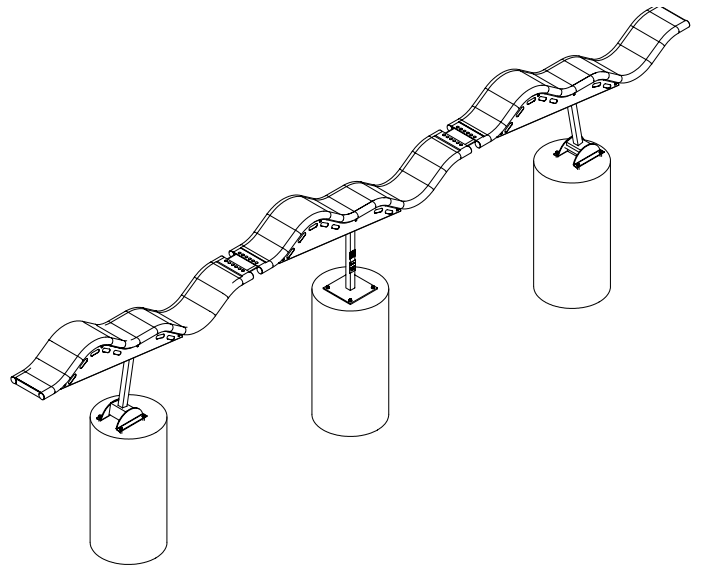

Snap a chalk line down the center of the concrete footings. Turn the X-Wave over onto the legs and place on top of the concrete footings aligning it to the center mark. Verify that the leg bases are 98" center to center and mark the mounting holes. Drill the mounting holes and secure the torsion legs to the concrete using twelve concrete wedge anchors (18). At this time fully tighten all hardware on the X-Wave to a torque value of 70 ft-lbs.

# X-Wave<sup>2</sup> Specific Install Step

Fixing the side panels to the seats

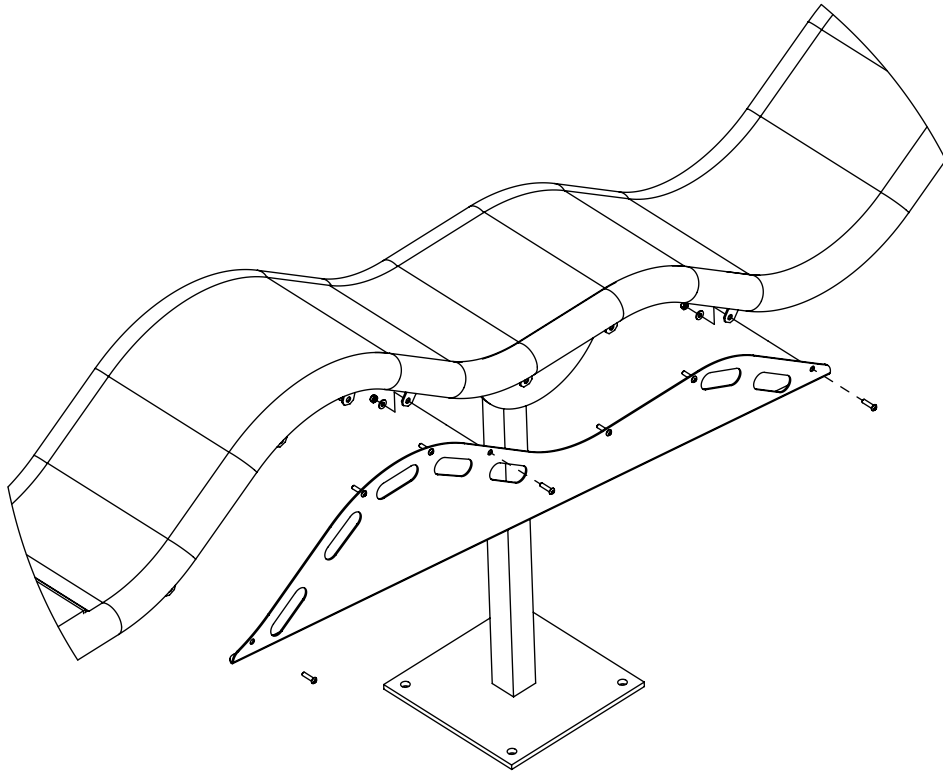

Fasten the six side panels to the X-Wave using four 5/16"-18 x .875" button head screws (12), eight washers (14) and four lock nuts (13) per panel.

# X-Wave<sup>2</sup> Maintenance Schedule

Regular inspection and maintenance of all parts and fasteners is recommended. At a minimum, the following inspections should be completed:

Prior to first use:

- Grease all bearings with a common multi purpose grease.
- Replace grease fitting with the provided plugs (save fitting for future use, otherwise a new one will need to be purchased).
- Ensure all hardware is securely fastened.
- Inspect bolts to ensure that only 2 threads are exposed past any nut. (If necessary, correct by adding a washer or removing the appropriate length from the bolt.)

Monthly:

- Inspect product for wear and/or damage
- Tighten all hardware connections
- Check assembly for any signs of wear or vandalism
- Replace broken or worn parts immediately or take equipment out of service until repairs are made
- To restore coating to its original luster, wash/rinse/dry and use a quality vinyl protectant
- Inspect ground surface to ensure 6" minimum of surfacing at all times

Annually:

- Grease all bearings

\*\*\*All warranties are only valid if products are installed and maintained in accordance with Xccent's instructions and approved parts\*\*\*

## Warning and Manufacturing Labels

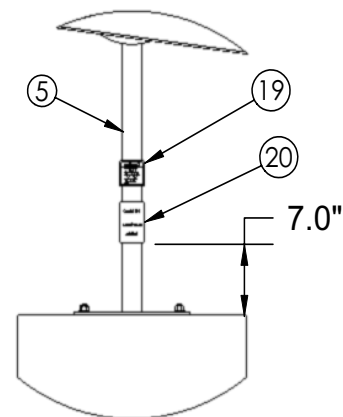

All stickers are to be centered vertically on the center leg of the X-Wave<sup>2</sup>. Be sure post surface is clean before applying stickers. Xccent recommends cleaning the surface with an alcohol wipe to remove all dirt for optimal adherence.